

AWWA C207 Class D Ring & Blind

*Pressure rating at atmospheric temp: 175 - 150 PSI

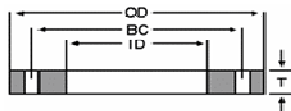

Nominal Size	Outside Diameter	Inside Diameter	Thick. Of Flange		Number of Bolt Holes	Diam. of Bolt Holes	Diam. of Bolt Circle	Weight (lbs)	
			Slip-On	Blind				Slip-on	Blind
	OD	ID	T	T			BC		
4	9.00	4.57	0.625	0.625	8	0.750	7.50	8	11
5	10.00	5.66	0.625	0.650	8	0.875	8.50	9	14
6	11.00	6.72	0.688	0.693	8	0.875	9.50	11	19
8	13.50	8.72	0.688	0.812	8	0.875	11.75	15	33
10	16.00	10.88	0.688	0.953	12	1.000	14.25	19	54
12	19.00	12.88	0.812	1.117	12	1.000	17.00	33	90
14	21.00	14.19	0.933	1.133	12	1.125	18.75	47	111
16	23.50	16.19	1.000	1.265	16	1.125	21.25	60	155
18	25.00	18.19	1.062	1.331	16	1.250	22.75	64	185
20	27.50	20.19	1.125	1.448	20	1.250	25.00	79	244
22	29.50	22.19	1.188	1.568	20	1.375	27.25	90	304
24	32.00	24.19	1.250	1.661	20	1.375	29.50	112	378
26	34.25	26.19	1.312	1.786	24	1.375	31.75	129	466
28	36.50	28.19	1.312	1.906	28	1.375	34.00	141	565
30	38.75	30.19	1.375	2.008	28	1.375	36.00	164	671
32	41.75	32.19	1.500	2.150	28	1.625	38.50	211	834
34	43.75	34.19	1.500	2.252	32	1.625	40.50	220	959
36	46.00	36.19	1.625	2.370	32	1.625	42.75	261	1116
38	48.75	38.19	1.625	2.506	32	1.625	45.25	301	1325
40	50.75	40.19	1.625	2.509	36	1.625	47.25	313	1438
42	53.00	42.19	1.750	2.729	36	1.625	49.50	364	1706
44	55.25	44.19	1.750	2.849	40	1.625	51.75	387	1935
46	57.25	46.19	1.750	2.952	40	1.625	53.75	404	2153
48	59.50	48.19	1.875	3.072	44	1.625	56.00	460	2420
50	61.75	50.19	2.000	3.196	44	1.875	58.25	507	2712
52	64.00	52.19	2.000	3.315	44	1.875	60.50	542	3021
54	66.25	54.19	2.125	3.435	44	1.875	62.75	614	3355
60	73.00	60.19	2.250	3.779	52	1.875	69.25	763	4481
66	80.00	66.19	2.500	4.136	52	1.875	76.00	1021	5890
72	86.50	72.19	2.625	4.480	60	1.875	82.50	1203	7458
78	93.00	78.19	2.750		64	2.125	89.00	1374	
84	99.75	84.19	2.875		64	2.125	95.50	1646	
90	106.50	90.19	3.000		68	2.438	102.00	1872	
96	113.25	96.19	3.250		68	2.438	108.50	2291	
102	120.00	102.19	3.250		72	2.688	114.50	2485	
108	126.75	108.19	3.375		72	2.688	120.75	2884	
114	133.50	114.19	3.500		76	2.938	126.75	3214	
120	140.25	120.19	3.500		76	2.938	132.75	3558	
126	147.00	126.19	3.750		80	3.188	139.25	4065	
132	153.75	132.19	3.875		80	3.188	145.75	4614	
138	160.50	138.19	4.000		84	3.438	152.00	5047	
144	167.25	144.19	4.125		84	3.438	158.25	5680	

- All Dimensions are in inches.
- Furnished flat face unless otherwise specified.
- Other bores and facings available upon request.
- Bores for sizes larger than 24" are not specified by AWWA. It is recommended by AWWA that bore should be 0.19 inch larger than nominal OD of the pipe.
- Blind Flanges: Over 48", designers should consider using dished heads welded to a standard flange.
- Drill Template: To match ANSI B16.1, class 125 cast-iron flanges. In sizes 24" and smaller it also matches ANSI B16.5, 150# std for steel flanges.
- Bolt Hole Diameter is 1/8" larger than nominal diameter of the bolt, except it is 3/16" larger than nominal dia of the bolt on flanges larger than 84"
- Ring dimensions from AWWA C207-01 Table 2
Blind dimensions from AWWA C207-01 Table 7

Sumitec Int'l, Inc

Phone (877)-837-9618 Fax (866) 311-5335 email:sumitecsales@comcast.net

We also Supply Carbon and Stainless Steel Buttweld Fittings and Pipes