

End Caps - ANSI B16.9

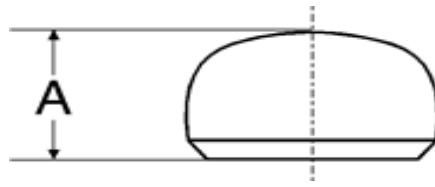

Nominal Pipe Size	Common OD at Bevel		T		Length				Weight 40S/STD Lbs/piece
					Dimension				
	A								
	For wall $\leq T$				For wall $> T$				
	in	mm	in	mm	in	mm	in	mm	
1/2	0.84	21.00	0.18	3.73	1.00	25.00	1.00	25.00	0.09
3/4	1.05	27.00	0.15	3.91	1.00	25.00	1.00	25.00	0.11
1	1.32	33.00	0.18	4.55	1.50	38.00	1.50	38.00	0.24
1 1/4	1.66	42.00	0.19	4.85	1.50	38.00	1.50	38.00	0.31
1 1/2	1.90	48.00	0.20	5.08	1.50	38.00	1.50	38.00	0.37
2	2.38	60.00	0.22	5.54	1.50	38.00	1.75	44.00	0.51
2 1/2	2.88	73.00	0.28	7.01	1.50	38.00	2.00	51.00	0.86
3	3.50	89.00	0.30	7.62	2.00	51.00	2.50	64.00	1.45
3 1/2	4.00	102.00	0.32	8.08	2.50	64.00	3.00	76.00	-
4	4.50	114.00	0.34	8.56	2.50	64.00	3.00	76.00	2.57
5	5.56	141.00	0.38	9.53	3.00	76.00	3.50	89.00	4.20
6	6.62	168.00	0.43	10.97	3.50	89.00	4.00	102.00	6.38
8	8.62	219.00	0.50	12.70	4.00	102.00	5.00	127.00	11.42
10	10.75	273.00	0.50	12.70	5.00	127.00	6.00	152.00	20.13
12	12.75	324.00	0.50	12.70	6.00	152.00	7.00	178.00	29.26
14	14.00	356.00	0.50	12.70	6.50	165.00	7.50	191.00	34.98
16	16.00	406.00	0.50	12.70	7.00	178.00	8.00	203.00	44.00
18	18.00	457.00	0.50	12.70	8.00	203.00	9.00	229.00	56.32
20	20.00	508.00	0.50	12.70	9.00	229.00	10.00	254.00	70.18
22	22.00	559.00	0.50	12.70	10.00	254.00	10.00	254.00	85.36
24	24.00	610.00	0.50	12.70	10.50	267.00	12.00	305.00	45.10
26	26.00	660.00	-	-	10.50	267.00			53.80
28	28.00	711.00	-	-	10.50	267.00			62.40
30	30.00	762.00	-	-	10.50	267.00			71.70
32	32.00	813.00	-	-	10.50	267.00			81.60
34	34.00	864.00	-	-	10.50	267.00			-
36	36.00	914.00	-	-	10.50	267.00			103.00
38	38.00	965.00	-	-	12.00	305.00			-
40	40.00	1016.00	-	-	12.00	305.00			127.00
42	42.00	1067.00	-	-	12.00	305.00			140.00
44	44.00	1118	-	-	13.50	343.00			-
46	46.00	1168.00	-	-	13.50	343.00			-
48	48.00	1219.00	-	-	13.50	343.00			-

FITTINGS THROUGH 100" PIPE SIZE ARE AVAILABLE

Sumitec Int'l, Inc

Phone (877)-837-9618 Fax (866) 311-5335 email:sumitecsales@comcast.net

We also Supply Carbon and Stainless Steel Flanges and Pipes