

Short Radius Elbows and Returns - ANSI B16.28

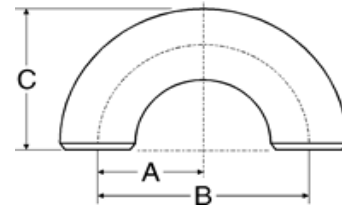
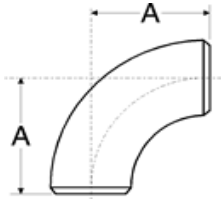

Dimensions (based on ASME/ANSI B16.28) and example weights for short radius elbows and returns

Nominal Pipe Size	Common		90° Elbow			180° Return				40S/STD1 Weight Lbs/piece
	OD at Bevel		Dimension		40S/STD1 Weight Lbs/piece	Dimension				
	in	mm	A			B		C		
1	1.32	33.00	1.00	25.00	0.26	2.00	51.00	1.62	41.00	0.53
1 1/4	1.66	42.00	1.25	32.00	0.44	2.50	64.00	2.06	52.00	0.88
1 1/2	1.90	48.00	1.50	38.00	0.64	3.00	76.00	2.44	62.00	1.06
2	2.38	60.00	2.00	51.00	1.12	4.00	102.00	3.19	81.00	2.24
2 1/2	2.88	73.00	2.50	64.00	2.24	5.00	127.00	3.94	100.00	4.49
3	3.50	89.00	3.00	76.00	3.30	6.00	152.00	4.75	121.00	6.60
3 1/2	4.00	102.00	3.50	89.00	4.53	7.00	178.00	5.50	140.00	9.06
4	4.50	114	4.00	102.00	6.86	8.00	203.00	6.25	159.00	13.73
5	5.56	141.00	5.00	127.00	11.62	10.00	254.00	7.75	197.00	23.32
6	6.62	168.00	6.00	152.00	17.47	12.00	305.00	9.31	237.00	34.98
8	8.62	219.00	8.00	203.00	37.62	16.00	406.00	12.31	313.00	78.10
10	10.75	273.00	10.00	254.00	62.92	20.00	508.00	15.38	391.00	125.84
12	12.75	324.00	12.00	305.00	79.86	24.00	610.00	18.38	467.00	159.72
14	14.00	356.00	14.00	356.00	100.76	28.00	711.00	21.00	533.00	201.52
16	16.00	406.00	16.00	406.00	130.68	32.00	813.00	24.00	610.00	261.36
18	18.00	457.00	18.00	457.00	174.68	36.00	914.00	27.00	686.00	349.36
20	20.00	508.00	20.00	508.00	214.50	40.00	1016.00	30.00	762.00	429.00
22	22.00	559.00	22.00	559.00	-	44.00	1118	33.00	838.00	-
24	24.00	610.00	24.00	610.00	301.40	48.00	1219.00	36.00	914.00	602.80

Notes
 Dimension A = One half of dimension B
 Dimensions quoted in mm are 'Nominal' values from B16.28 (i.e. rounded equivalents of the inch dimensions).
 Refer to B16.28 for additional 'Max' and 'Min' metric dimensions.

FITTINGS THROUGH 100" PIPE SIZE ARE AVAILABLE

Sumitec Int'l, Inc

Phone (877)-837-9618 Fax (866) 311-5335 email:sumitecsales@comcast.net

We also Supply Carbon and Stainless Steel Flanges and Pipes