

ANSI B16.5 Class 900 Slip-On Flanges

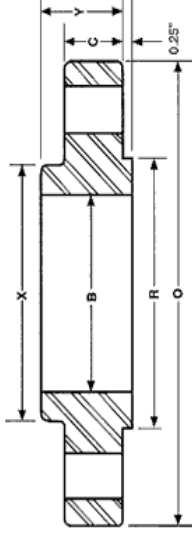

Nominal Size	Outside Diameter O	Thickness C	Dia Of Raised Face R	Dia. Of Hub At Base X	Length Thru Hub Y	Inside Diameter B	No. Of Holes	Dia. of holes	Dia. Of Bolts	Dia. Of Bolt Circle	Approx. Weight (Lbs)
1/2"	4.75	0.88	1.38	1.50	1.25	0.88	4	0.88	3/4	3.25	4
3/4"	5.12	1.00	1.69	1.75	1.38	1.09	4	0.88	3/4	3.50	5
1"	5.88	1.12	2.00	2.06	1.62	1.36	4	1.00	7/8	4.00	8
1 1/4"	6.25	1.12	2.50	2.50	1.62	1.70	4	1.00	7/8	4.38	9
1 1/2"	7.00	1.25	2.88	2.75	1.75	1.95	4	1.12	1	4.88	12
2"	8.50	1.50	3.62	4.12	2.25	2.44	8	1.00	7/8	6.50	25
2 1/2"	9.62	1.62	4.12	4.88	2.50	2.94	8	1.12	1	7.50	36
3"	9.50	1.50	5.00	5.00	2.12	3.57	8	1.00	7/8	7.50	26
4"	11.50	1.75	6.19	6.25	2.75	4.57	8	1.25	1 1/8	9.25	53
5"	13.75	2.00	7.31	7.50	3.12	5.66	8	1.38	1 1/4	11.00	83
6"	15.00	2.19	8.50	9.25	3.38	6.72	12	1.25	1 1/8	12.50	110
8"	18.50	2.50	10.62	11.75	4.00	8.72	12	1.50	1 3/8	15.50	170
10"	21.50	2.75	12.75	14.50	4.25	10.88	16	1.50	1 3/8	18.50	245
12"	24.00	3.12	15.00	16.50	4.62	12.88	20	1.50	1 3/8	21.00	325
14"	25.25	3.38	16.25	17.75	5.12	14.14	20	1.62	1 1/2	22.00	400
16"	27.75	3.50	18.50	20.00	5.25	16.16	20	1.75	1 5/8	24.25	425
18"	31.00	4.00	21.00	22.25	6.00	18.18	20	2.00	1 7/8	27.00	600
20"	33.75	4.25	23.00	24.50	6.25	20.20	20	2.12	2	29.50	730
24"	41.00	5.50	27.25	29.50	8.00	24.25	20	2.62	2 1/2	35.50	1400

Sumitec Int'l, Inc

Phone (877)-837-9618 Fax (866) 311-5335 email:sumitecsales@comcast.net

We also Supply Carbon and Stainless Steel Buttweled Fittings and Pipes